

MATERIAL FILTER

MAXIMUM INLET PRESSURE 6,000 PSI (414 BAR)



READ THIS MANUAL CAREFULLY BEFORE INSTALLING,
OPERATING OR SERVICING THIS EQUIPMENT.

THIS MANUAL COVERS THE FOLLOWING MODELS

	MODEL	MATERIAL TYPE	SCREEN MESH SIZE (PART NO.)	
	651414-40-B	CARBON STEEL	40 MESH (93944-40)	
	651414-70-B	CARBON STEEL	70 MESH (93944-70)	
	651414-100-B	CARBON STEEL	100 MESH (93944-100)	

SERVICE KITS

- ◇ Use only genuine ARO replacement parts to assure compatible pressure rating and longest service life.

Refer to Figure 3 to order replacement parts.

MATERIAL FILTER DATA

MODELS – See Model Description Chart for “-XXX” (Optional Screen)

MATERIAL – See Model Description Chart.

MAXIMUM FLUID PRESSURE – 6,000 p.s.i.g. (414 bar)

OPERATING & SAFETY PRECAUTIONS

- ◇ Read and heed all Warnings, Cautions, and Safety Precautions before operating this pump.

⚠ WARNING DO NOT EXCEED MAXIMUM INLET PRESSURE.

High pressure fluid can cause serious injury or property damage. Do not service or clean pump, hoses or dispensing valve while the system is pressurized.

- Disconnect air supply line and relieve pressure from the system by opening dispensing valve or device and/or carefully and slowly loosening and removing outlet hose or piping from pump.

GENERAL DESCRIPTION

Foreign material in the system can ruin the pump and other system components. Material filters and strainers are used to combat this problem and improve service life. A material strainer installed at the material inlet is used to separate foreign materials such as dirt, stones and sweeping compound, from the material and prevent it from entering the pumping system. The ARO Material Filter is installed in the system at the material (pump) outlet to prevent foreign material from obstructing the operation of the dispensing device.

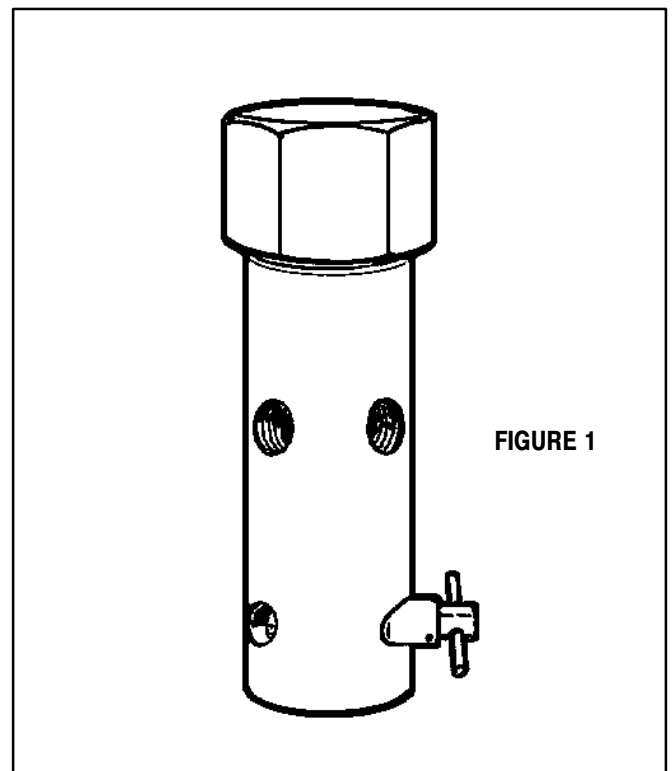

TYPICAL SYSTEM VIEW

1. Install material filter either at the inlet of material handling section or upstream from the other accessories (control handle etc.)
2. Refer to typical installation. (Figure 2)
3. The filter unit was tested at the factory with a maximum working pressure of 6,000 PSI. (414 PSI)
4. A Y17-12-C pipe plug is included with this unit to plug the inlet port not being used.

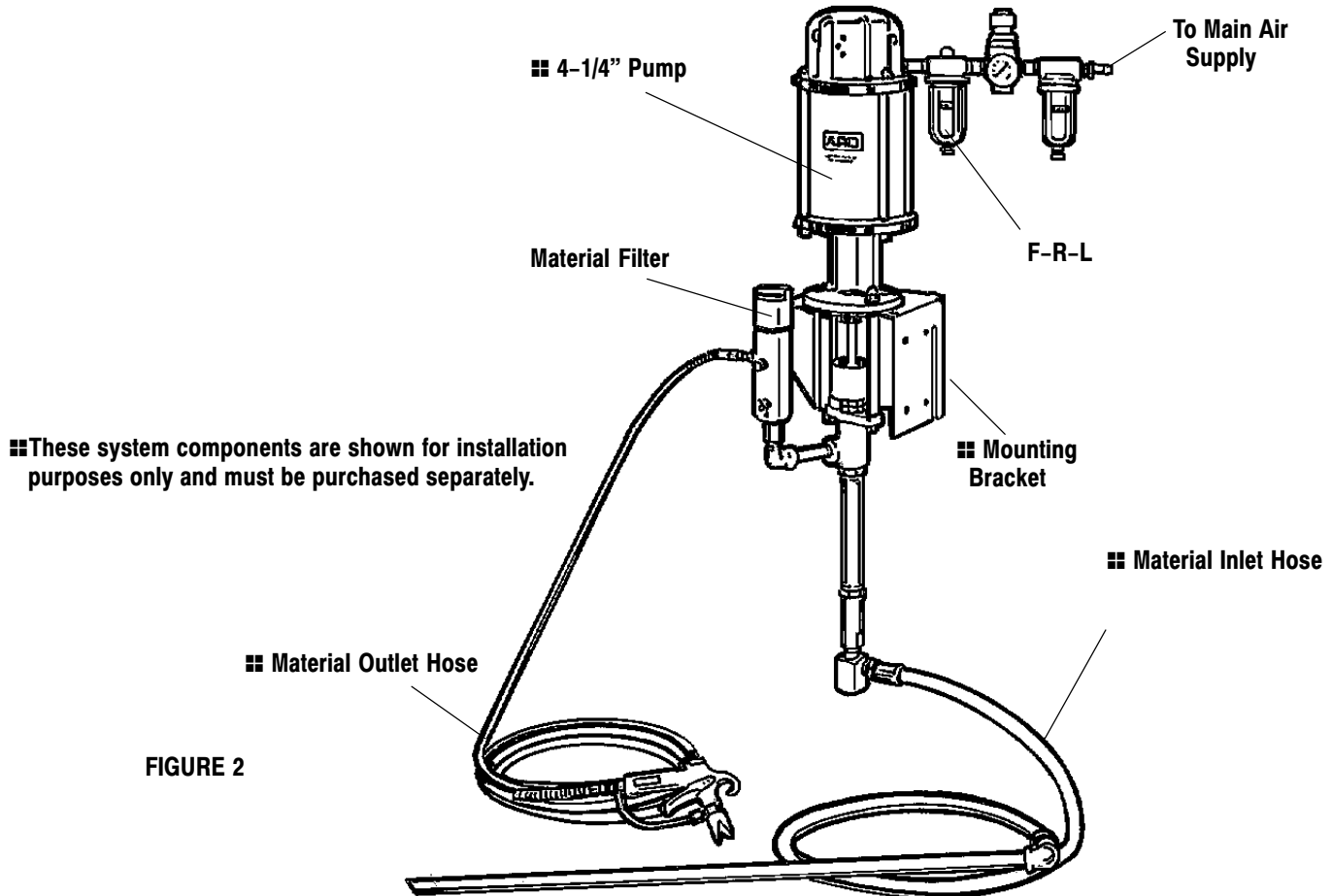

DISASSEMBLY

1. Unscrew and remove (1) Cap from the (16) Filter body.
 2. Remove (2) Gasket from (1) Cap.
 3. Remove (3) Spring and (4) Button Guide from the (16) Filter Body.
 4. Pull the (6) tube and (5) Ball from the (16) Filter Body.
 5. Unscrew the (12) Retainer and remove (13) Washer, (14) "O" Ring, (15) Ball Seat, (11) Gasket and (10) Ball.
 6. Unscrew (7) Valve and remove (8) pin and (9) "O" Ring.
- Reverse disassembly instructions for reassembly.

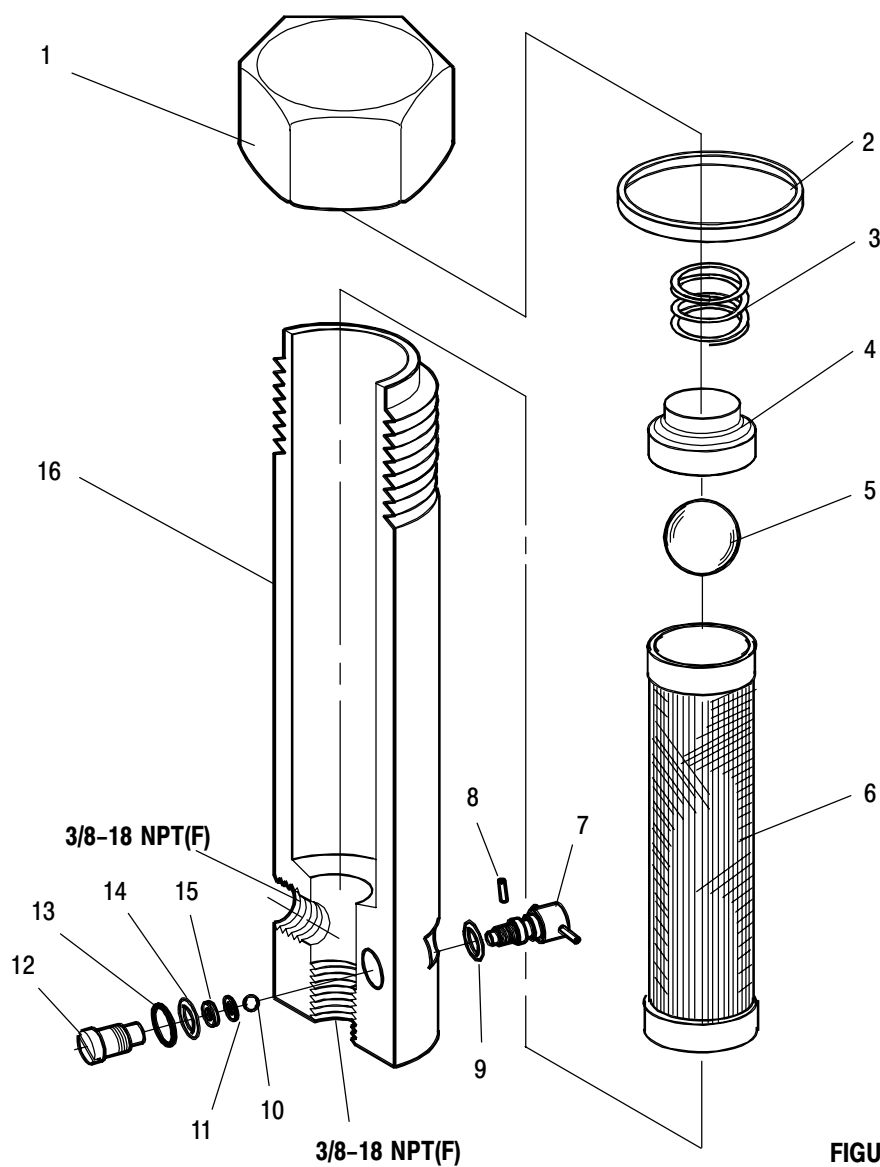

FIGURE 3

ITEM	DESCRIPTION	(QTY)	PART NO.	ITEM	DESCRIPTION	(QTY)	PART NO.
1	Cap	(1)	92990-1	9	"O" Ring	(1)	90404
2	Gasket	(1)	91447	10	Ball	(1)	90963
3	Spring	(1)	90408	11	Gasket	(1)	92476
4	Guide Button	(1)	93949	12	Retainer	(1)	92475
5	Ball	(1)	Y16-126	13	Washer	(1)	92900
6	Cartridge (See Chart, Page 1)	(1)	93944-XXX	14	"O" Ring	(1)	92477
7	Valve	(1)	65733	15	Ball Seat	(1)	90961
8	Pin	(1)	Y178-216	16	Filter Body	(1)	66884



Part of worldwide Ingersoll-Rand

PN 97999-004